



8 Catkin Road, Scunthorpe, DN16 3WB

£325,000

A spacious and extended four bed detached home in a quiet cul de sac position on this popular Bottesford estate. Set on a lovely south west facing plot, close to great school catchments, with good room sizes throughout and a fantastic open plan kitchen diner across the rear.

This property comprises of an entrance hall, kitchen diner, separate utility room, lounge, an extra reception room to the front and a downstairs W.C. To the first floor you have four bedrooms, three of which are doubles and a well proportioned single. Bedroom one and bedroom two also benefit from having en-suites and there is also a further modern family bathroom. Outside there's a nice sized rear garden with a decking area, garage and off road parking for up to three cars.

This property has a lot to offer and would make an ideal family home! For further information or to book a viewing, please get in touch.



Entrance hall



Utility room 8'9" x 6'0" (2.67 x 1.83)



Dining room 17'3" x 11'7" (5.27 x 3.55)



Downstairs W.C.

Garage 16'1" x 8'9" (4.92 x 2.67)

Landing

Bedroom one 13'3" x 11'7" (4.04 x 3.55)



Study 9'2" x 8'9" (2.81 x 2.67)

Lounge 17'3" x 9'2" (5.27 x 2.81)



Kitchen 20'9" x 13'3" (6.35 x 4.04)



En-suite



En-suite



Bedroom three 10'9" x 8'11" (3.30 x 2.72)



Bedroom two 13'11" x 10'6" (4.25 x 3.21)



Bedroom four 7'6" x 6'11" (2.30 x 2.11)



Family bathroom 6'6" x 5'6" (2.00 x 1.69)



Outside





Floor Plan

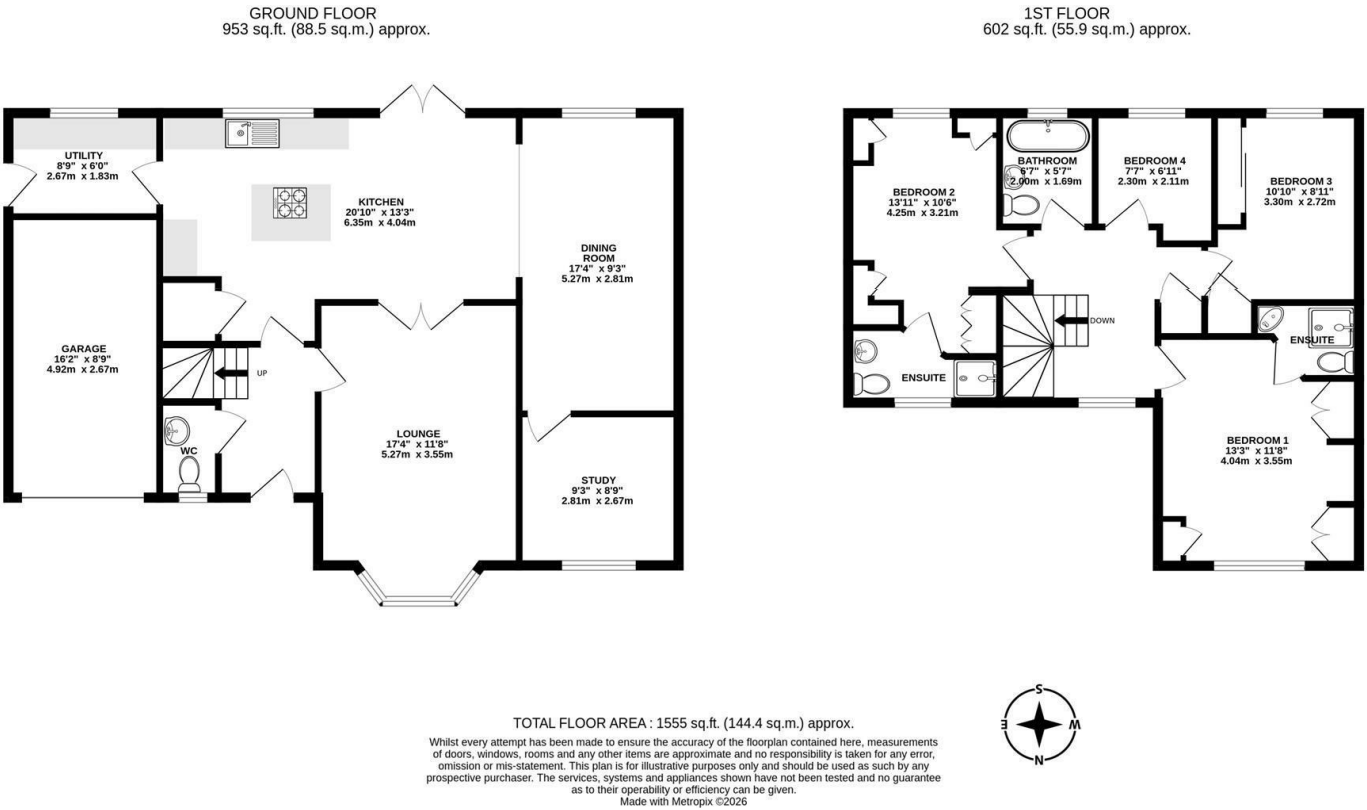

Area Map

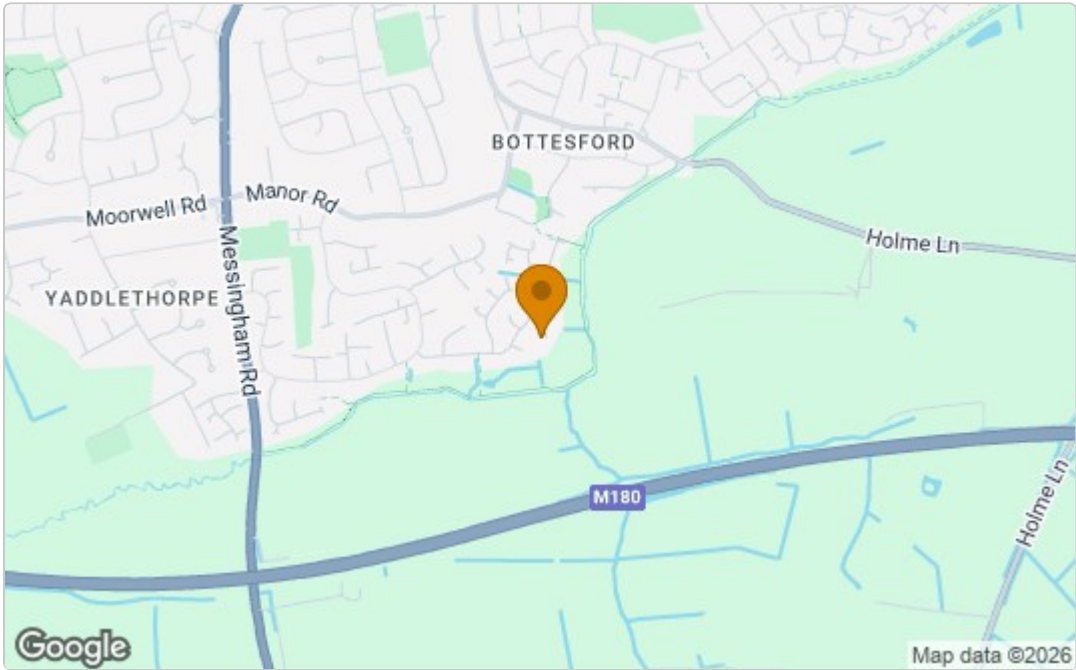

Energy Efficiency Graph

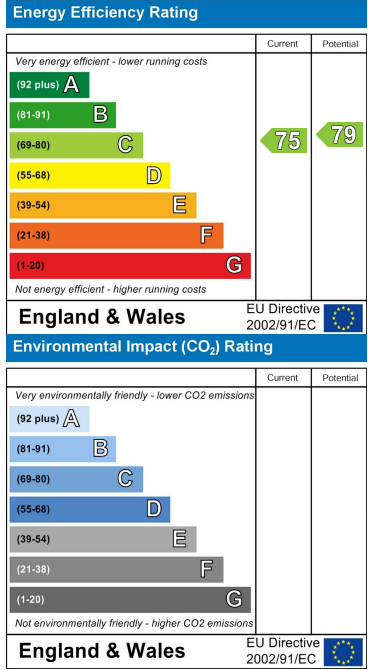

These particulars, whilst believed to be accurate are set out as a general outline only for guidance and do not constitute any part of an offer or contract. Intending purchasers should not rely on them as statements of representation of fact, but must satisfy themselves by inspection or otherwise as to their accuracy. No person in this firms employment has the authority to make or give any representation or warranty in respect of the property.